

JOHN DEERE
WORLDWIDE COMMERCIAL & CONSUMER
EQUIPMENT DIVISION

Utility Cart
17AT

OMM157172 D7

OPERATOR'S MANUAL



JOHN DEERE

All information, illustrations and specifications in this manual are based on the latest information at the time of publication. The right is reserved to make changes at any time without notice.

COPYRIGHT© 2007
Deere & Co.

John Deere Worldwide Commercial and
Consumer Equipment Division
All rights reserved
Previous Editions
COPYRIGHT©

North American Version
Litho in U.S.A.

PRODUCT IDENTIFICATION

CAUTION

Product Identification

Product Compatibility

This utility cart is designed for use with T-Series, HPX, and XUV Gator™ Utility Vehicles only.

Record Purchase Information

Record your purchase information in the spaces provided below.

DATE OF PURCHASE:

DEALER NAME:

DEALER PHONE:

Safety Labels



Understanding The Machine Safety Labels

The machine safety labels shown in this section are placed in important areas on your machine to draw attention to potential safety hazards.

On your machine safety labels, the words DANGER,

WARNING, and CAUTION are used with this safety-alert symbol.

DANGER identifies the most serious hazards.

The operator's manual also explains any potential safety hazards whenever necessary in special safety messages that are identified with the word, CAUTION, and the safety-alert symbol.



B7110

TO HELP PREVENT BODILY INJURY OR EQUIPMENT DAMAGE

- Read owner's manual
- Do not ride in cart
- Do not exceed 30 mph
- Do not exceed towing capacity listed in vehicle's manual
- Reduce load on slopes and slippery areas
- Cart is not intended for use on highways or public roads

SAFETY

WARNING



AVOID INJURY FROM EXPLOSION

- Do not place gas container in cart when filling

RIDERS CAN FALL OFF AND BE KILLED

- No riders in cart

Safety

Read the general safety operating precautions in your machine operator's manual for additional safety information.

Operate Safely

- This attachment is intended for use in lawn care and home applications. Do not tow behind a vehicle on a highway or in any high speed application. Do not tow at speeds higher than maximum recommended towing speed.
- Towing speed should always be slow enough to maintain control. Travel slowly over rough ground.
- Do not let children or an untrained person operate machine.
- Do not let anyone, especially children, ride on machine or attachment. Riders are subject to injury such as being struck by foreign objects and being thrown off. Riders may also obstruct the operator's view, resulting in the machine being operated in an unsafe manner.
- Check machine brake action before you operate. Adjust or service brakes as necessary.
- Keep all nuts and bolts tight to be sure the equipment is in safe working condition.
- Keep all parts in good condition and properly installed. Fix damage immediately. Replace worn or broken parts. Replace all worn or damaged safety and instruction decals.
- Do not modify machine or safety devices. Unauthorized modifications to the machine or attachment may impair its function and safety.
- Securely anchor all loads to prevent loads from falling.
- Distribute load evenly for safe travel and unloading of cart.
- Do not obstruct the operator's view during use.

Towing Loads Safely

- Stopping distance increases with speed and weight of towed load. Travel slowly and allow extra time and distance to stop.

- Total towed weight must not exceed limits specified in towing vehicle operator's manual.
- Excessive towed load can cause loss of traction and loss of control on slopes. Reduce towed weight when operating on slopes.
- Never allow children or others in or on towed equipment.
- Use only approved hitches. Tow only with a machine that has a hitch designed for towing. Do not attach towed equipment except at the approved hitch point.
- Follow the manufacturer's recommendations for weight limits for towed equipment and towing on slopes. Use counterweights or wheel weights as described in the machine operator's manual.
- Do not turn sharply. Use additional caution when turning or operating under adverse surface conditions. Use care when reversing.
- Do not shift to neutral and coast downhill.

Protect Bystanders

- Keep bystanders away when you operate a towed attachment.
- Before you back machine and attachment, look carefully behind attachment for bystanders.

Keep Riders Off Towed Attachment

Keep riders off of a towed attachment.

Riders on a towed attachment are subject to injury, such as being struck by objects and being thrown off the attachment during sudden starts, stops and turns.

Riders obstruct the operator's view, resulting in the attachment being used in an unsafe manner.

Keep riders off of hitch bracket.

Avoid Injury From Drawbar

Before you disconnect an attachment from machine hitch plate:

- Unload attachment.
- Stop attachment on level ground.
- Stop machine engine.
- Lock machine park brake.
- Block attachment wheels.
- Make sure hands, feet or other body parts are not under drawbar.

ASSEMBLY

Parts in Kit

Assembly

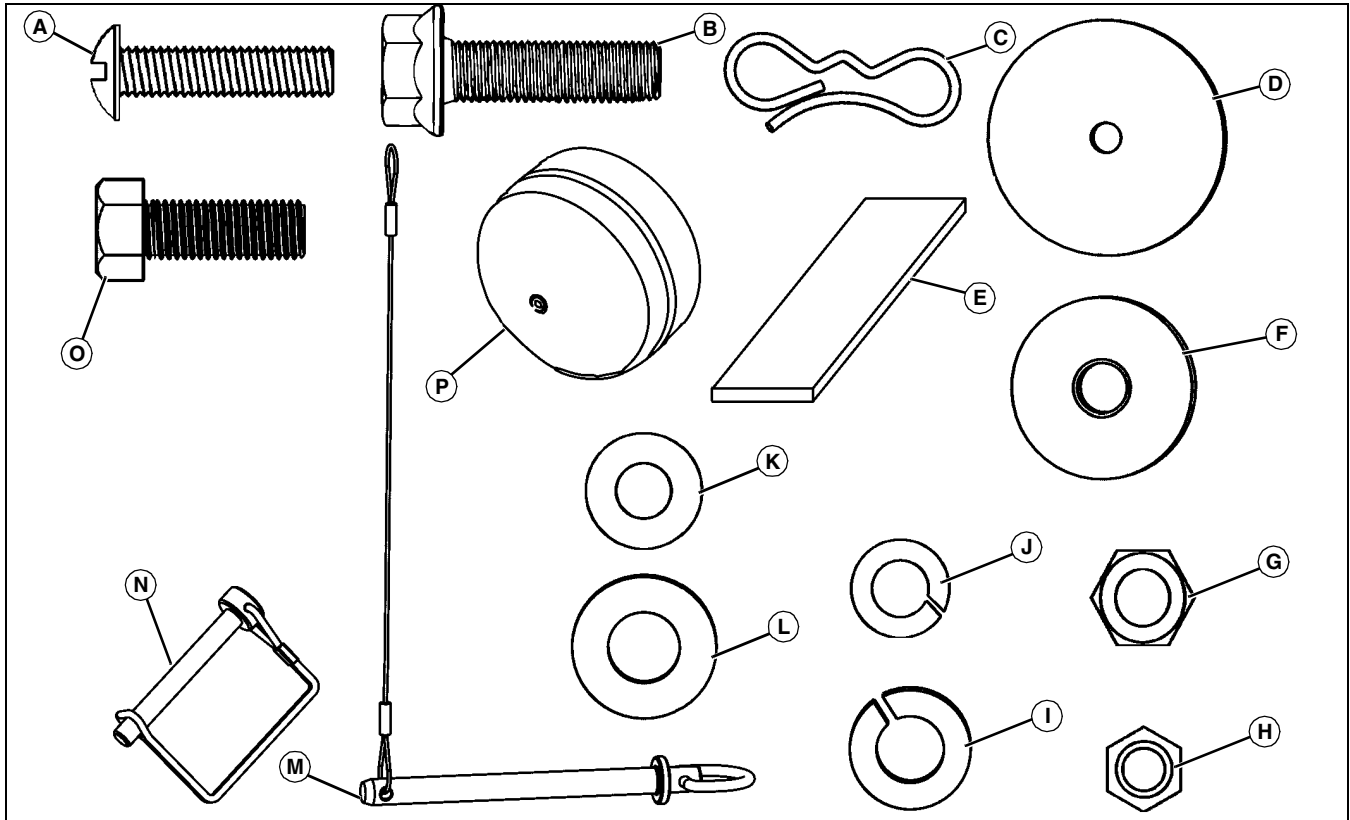

MX38954

Bag of Parts (Hardware)

Parts in Kit (Not Shown)

| Qty. | Description |
|------|--|
| 20 | Slotted Head Screw, 5/16 x 1-1/4 in. (A) |
| 2 | Bolt, 5/16 x 1-1/8 in. (B) |
| 1 | Locking Clip (C) |
| 2 | Washer, Wheel Hub (D) |
| 1 | Pad, Rubber (E) |
| 2 | Washer, Thick Wheel (F) |
| 5 | Nut, 3/8 in. (G) |
| 20 | Nut, 5/16 in. (H) |
| 5 | Lockwasher, 3/8 in. (I) |
| 20 | Lockwasher, 5/16 in. (J) |
| 40 | Washer, Flat, 5/16 in. (K) |
| 5 | Washer, Flat, 3/8 in. (L) |
| 1 | Pin, w/wire (M) |
| 1 | Pin, Hitch (N) |
| 5 | Bolt, 3/8 x 3/4 in. (O) |
| 2 | Hub Cap, Wheel (P) |

| Qty. | Description |
|------|--------------------------|
| 1 | Cart |
| 1 | Fender, Right |
| 1 | Fender, Left |
| 2 | Support, Side |
| 2 | Support, Front and Rear |
| 1 | Lock Bracket |
| 1 | Axle Support |
| 1 | Axle |
| 2 | Wheel |
| 1 | Drawbar |
| 1 | Hitch Coupler, 1-7/8 in. |

ASSEMBLY

Tools Required

Tools required for assembly:

- 1/2 in. wrench (1)
- 9/16 in. wrench (2)
- Pliers
- Flat blade screwdriver
- Torque wrench

Assemble Cart

When assembling cart, do the following

- Do not discard cardboard bed divider, it can be used as a template for making dividers for the cart.
- Place pieces of carton under cart box to help avoid scratching finish.
- Put all bolt heads to the inside of the cart box.

Install Supports

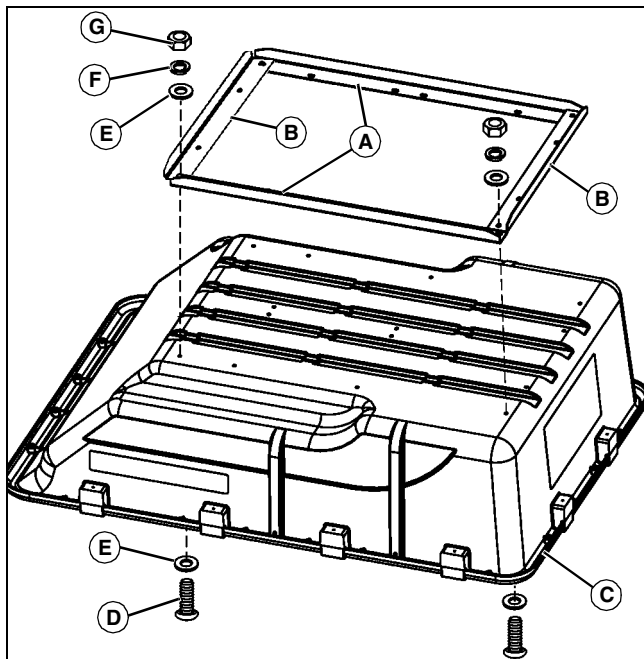

MX38955

1. Place the side supports (A) and then the front and rear supports (B) over the bottom of the cart (C).
2. Secure supports with four 5/16 x 1-1/4 in. slotted head screws (D), eight 5/16 in. flat washers (E), four 5/16 in. lockwashers (F), and four 5/16 in. nuts (G). Assemble hardware finger tight until all four screws are installed. Do not tighten nuts at this time.

Install Axle Support

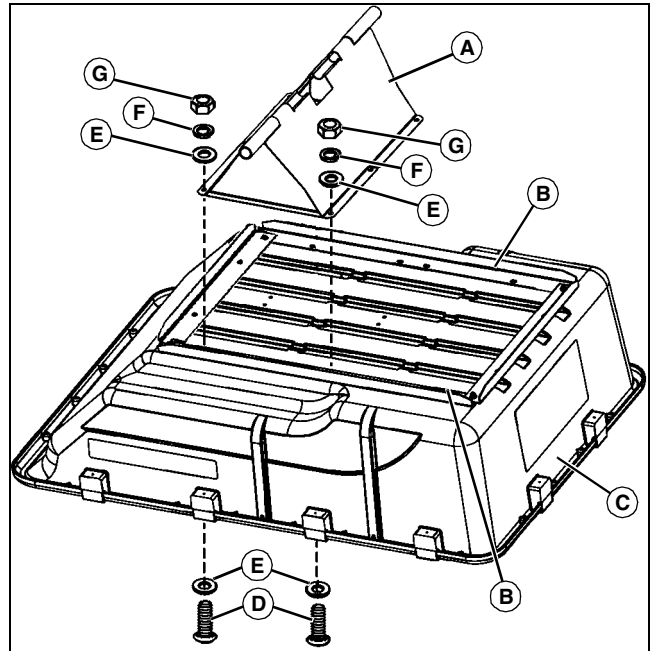

MX38956

1. Place axle support (A) onto slotted holes in side supports (B) on bottom of cart (C).
2. Install eight 5/16 x 1-1/4 in. slotted head screws (D) and eight 5/16 in. flat washers (E), from inside cart box through axle support. Place eight additional 5/16 in. flat washers (E), eight 5/16 in. lockwashers (F) and eight 5/16 in. nuts (G) on screws. Assemble hardware finger tight until all eight screws are installed. Do not tighten nuts at this time.

Install Fenders

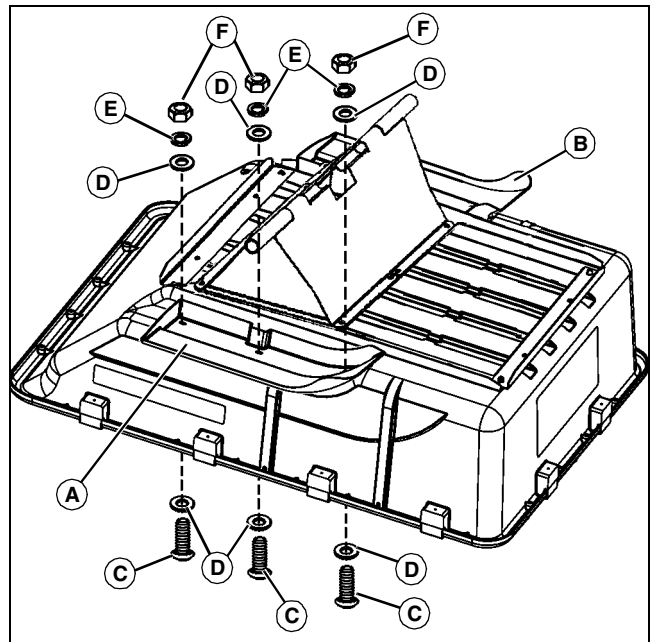

MX38958

1. Place left fender (A) and right fender (B) onto bottom of cart, as shown.
2. Secure fenders with six 5/16 x 1-1/4 in. slotted head screws (C) and six 5/16 in. flat washers (D), from inside cart box. Place six additional 5/16 in.

ASSEMBLY

flat washers (D), six 5/16 in. lockwashers (E) and six 5/16 in. nuts (F) on screws. Assemble hardware finger tight until all six screws are installed. Tighten nuts.

Install Lock Bracket

NOTE: Make sure U-shaped area on lock bracket is facing to the front of the cart.

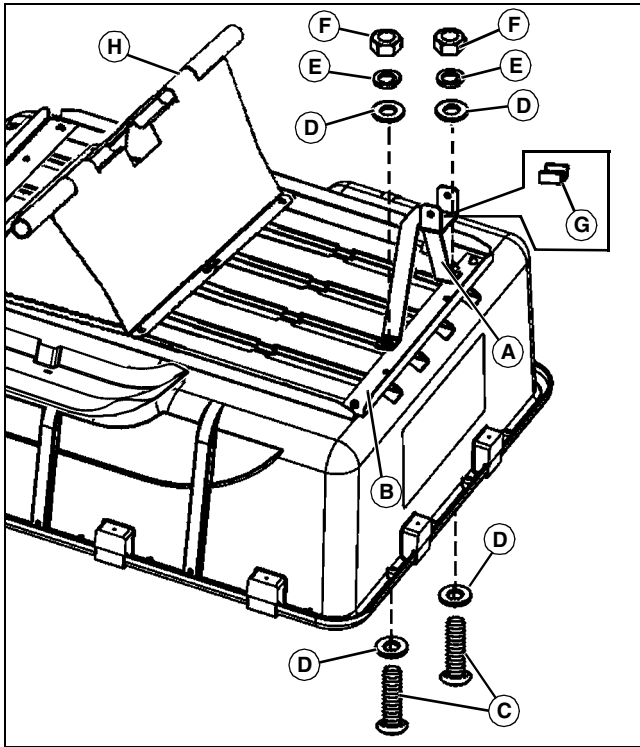

MX38957

1. Place lock bracket (A) onto front support (B) on cart.
2. Install two 5/16 x 1-1/4 in. slotted head screws (C) and two 5/16 in. flat washers (D) through cart box (from inside cart box) and lock bracket.

NOTE: Lock bracket has slots in it to adjust forward or backward.

3. Secure with two additional 5/16 in. flat washers (D), two 5/16 in. lockwashers (E) and two 5/16 in. nuts (F).
4. Remove paper backing from outside of rubber pad (G), and install into U-shaped area on lock bracket (A).
5. Tighten all fasteners for side supports, front and rear supports, and axle support (H). Do not tighten lock bracket (A) hardware at this time.

Assemble Drawbar

Assemble Pin to Drawbar

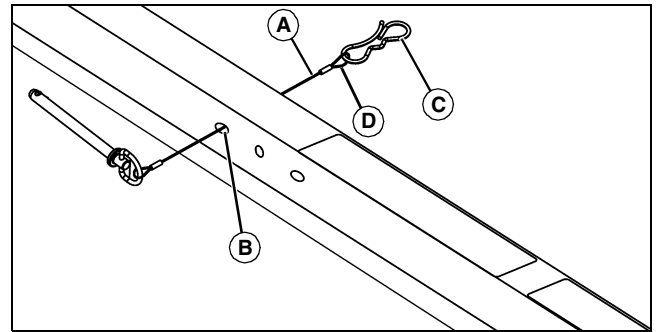

MX39214

1. Thread wire (A) end of pin w/wire through rear hole (B) in drawbar.
2. Hook locking clip (C) through loop (D) at end of wire.

Assemble Hitch to Drawbar

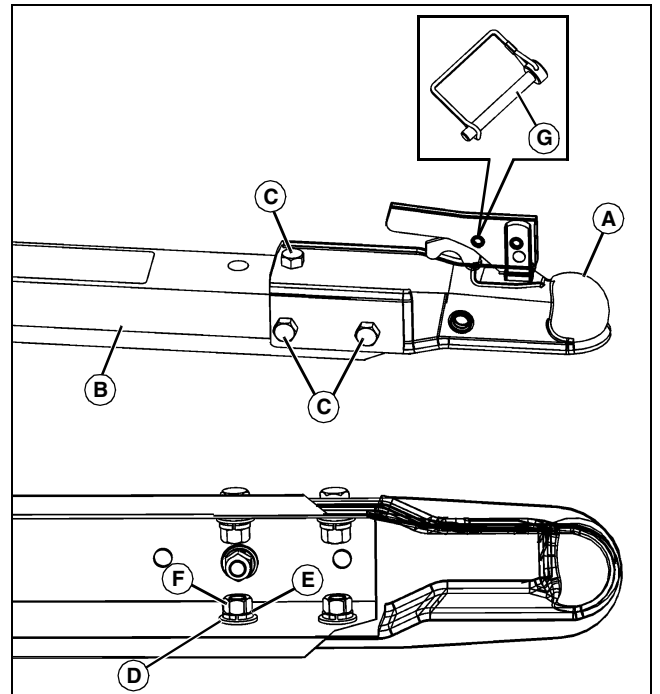

MX39215

1. Place hitch (A) on drawbar (B).
2. Install five 3/8 x 3/4 in. hex bolts (C) through hitch and drawbar.
3. Secure all five bolts with five 3/8 in. flat washers (D), 3/8 in. lockwashers (E), and 3/8 in. hex nuts (F).
4. Open and install hitch pin (G) to hitch to lock hitch in the closed position.

INSTALLING

Install Cart Drawbar and Axle

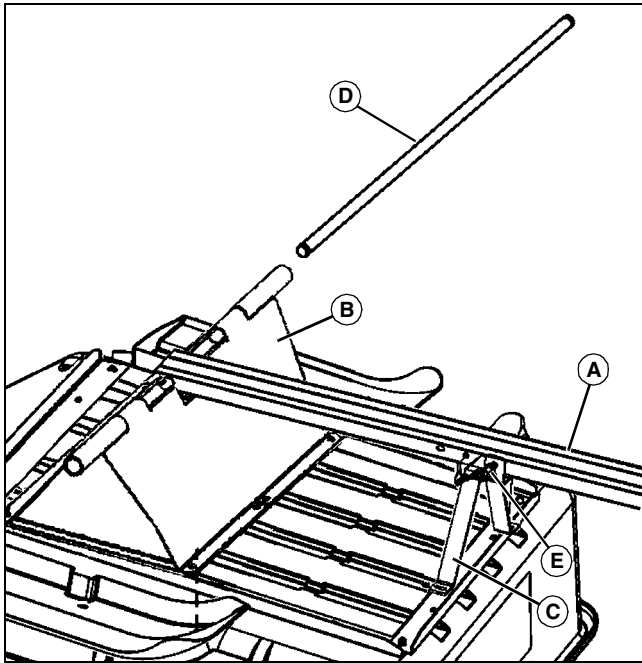

MX39216

1. Place drawbar (A) onto axle support (B) and lock bracket (C).

NOTE: A light coating of grease or oil on axle will aid in inserting the axle through the axle support.

2. Slide axle (D) through axle support and drawbar.
3. Install pin (E) through lock bracket and drawbar and secure opposite side of pin with locking clip.
4. Tighten lock bracket (C) hardware.

Install Wheels

NOTE: Put a small amount of grease on each end of axle, before installing wheels. This will make installing wheels on axle easier.

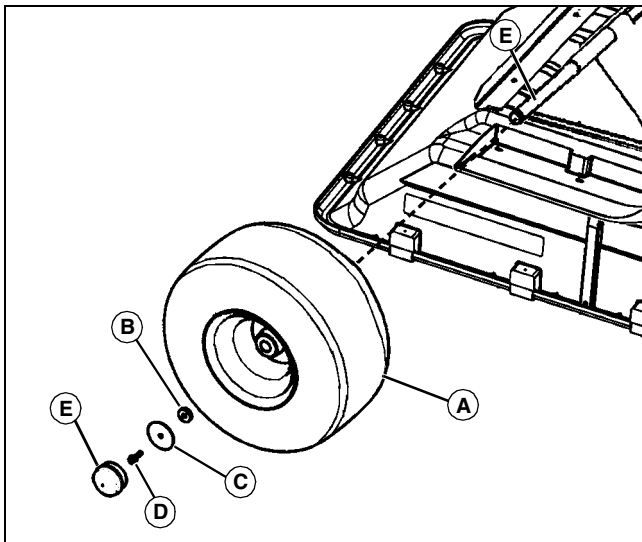

MX39217

1. Put one wheel (A) (valve stem to the outside) on axle.
2. Install one thick washer (B), wheel hub washer (C), and 5/16 x 1-1/8 in. bolt (D) on axle.

3. Repeat steps for other wheel.
4. After both wheels have been installed, tighten bolts to 34 N•m (25 lb-ft).
5. Push hub cap (E) over wheel hub washer (C) on each wheel.
6. Inflate tires to correct tire pressure.

Installing

Installing Cart

1. Park machine safely. (See Parking Safely in the Safety section.)

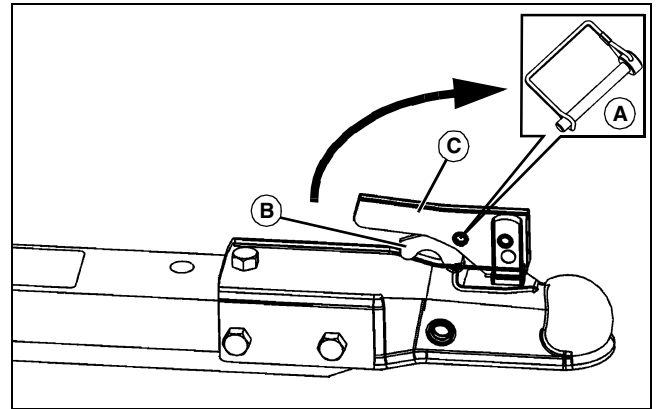

MX39218

2. If installed, remove hitch pin (A) from hitch.
 3. Press locking tab (B) upward, and pull lever (C) upward to release from locked position.
 4. Align cart drawbar with machine drawbar.
- NOTE: Machine hitch height should be between 17 - 25 mm (7 - 10 in.). When the machine has available hitch height adjustments, adjust the hitch height to the lowest possible position.**
5. Place cart hitch onto machine receiver hitch.
 6. Push lever (C) downward to lock cart hitch onto machine receiver hitch.
 7. Install hitch pin to hitch to lock hitch in the closed position.

Removing

Removing Cart

1. Park machine safely. (See Parking Safely in the Safety section.)
2. Unload cart.



CAUTION: Avoid injury! Keep hands, feet and other body parts away from under drawbar.

3. Remove hitch pin.
4. Press locking tab upward, and pull lever upward to release from locked position.
5. Push cart away from machine. Block cart wheels.
6. Push lever downward and install hitch pin to lock position for storage.

OPERATING

Operating

Determining Weight for Cart

CAUTION: Avoid injury! Excessive towed load can cause loss of traction and loss of control on slopes. Stopping distance increases with speed and weight of towed load.

Total towed weight must not exceed combined weight of pulling machine, operator and front ballast, or the maximum capacity of the cart.

The following maximum loaded cart weight capacities are the average weight of each cart model loaded with dry sand leveled with the top of the cart.

| Model Cart | Loaded Weight Capacity |
|------------|------------------------|
| 17AT | 453 kg (1000 lb) |

The amount you can carry in your cart is dependent on two factors:

- the combined weight of the pulling machine, the operator weight, and potential front ballast,
- as well as the maximum capacity of the cart.

Begin by adding the operator weight to the machine weight. If this total is less than the maximum cart capacity, you can carry more in the cart by adding front ballast to the machine. You can continue to add ballast until you reach the maximum capacity of the cart.

The maximum capacity you carry in this cart cannot be more than the total of the machine weight, the weight of the operator and any ballast, or the maximum capacity of the cart.

Example:

| | |
|---------------------------|-----------------|
| If Towing Machine Weighs: | 226 kg (500 lb) |
| Add Your Weight: | 90 kg (200 lb) |
| Combined Weight Equals | 317 kg (700 lb) |

To maintain stability using the cart in this example, you cannot safely carry more than 317 kg (700 lb) without first adding additional ballast to the towing machine.

Unloading Cart

1. Park machine safely. (See Parking Safely in the Safety section.)



CAUTION: Avoid injury! Before dumping cart:

- Park machine safely.
- Before backing up, make sure area is clear of bystanders, especially children.
- Make sure cart is installed to the towing machine.

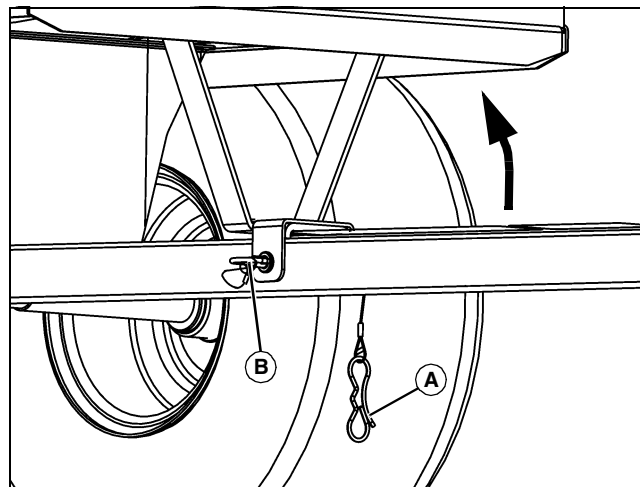

MX39219

2. Remove spring locking pin (A) from hitch pin (B), then remove hitch pin from drawbar.
3. Tilt cart box back and unload cart.
4. Push cart back into towing position, insert hitch pin (B) through drawbar and secure with spring locking pin (A).

Service

General Maintenance

NOTE: Unload cart before performing any maintenance or service.

- Wash cart bed after each use to avoid damage to bed or hardware.
- Check tire pressure with an accurate gauge, add or remove air if necessary.

Specifications

Model 17P Cart

| | |
|-----------------------|--------------------------------|
| Maximum Towing Speed | 48 kph (30 mph) |
| Box Capacity (Heaped) | 0.48 m ³ (17 cu ft) |
| Maximum Load | 453 kg (1000 lb) |
| Maximum Tongue Weight | 45 kg (100 lb) |
| Empty Weight | 47 kg (105 lb) |

Tires

| | |
|--------------------|-----------------|
| Size | 18.00x9.5 |
| Inflation Pressure | 69 kPa (10 psi) |

GETTING QUALITY SERVICE

Getting Quality Service

John Deere Quality Continues with Quality Service

John Deere provides a process to handle your questions or problems, should they arise, to ensure that product quality continues with quality parts and service support.

Follow the steps below to get answers to any questions you may have about your product.

1. Refer to your attachment and machine operator manuals.
2. In North America or Canada, call John Deere Special Services at 1-866-218-8622 and provide product serial number (if available) and model number.

GETTING QUALITY SERVICE
